

# Computer Troubleshooting Steps

## Computer Does Not Turn On:

1. Make sure you pressed the power button hard enough.
2. Check to make sure the power cable is connected to the desktop and electrical outlet. If unplugged, plug in the power cable. Press the power button.
3. Make sure there is power running into the room by surveying other computers to see if they have power.
4. Finally, ask your teacher for help.
5. Your teacher will contact the IT department.

By Edwin Salcedo



Click on the picture.  
You need to click on  
Format, Wrap Text  
and In Front of Text  
before you move the  
picture.

### Reminders:

- One space **after** each word
- One space **after** each period - (Correct: I went to the store.) (**Incorrect: I like pizza .**)
- One space **after** each comma - (Correct: I like pizza, chips, and candy.) (**Incorrect: I like pizza , chips , and candy.**)

# Computer How-To Steps

## How to Log Off:

1. Click on the Start button.
2. Click on the arrow next to Shut Down.
3. When the drop-down menu appears, choose Log Off.

By Edwin Salcedo

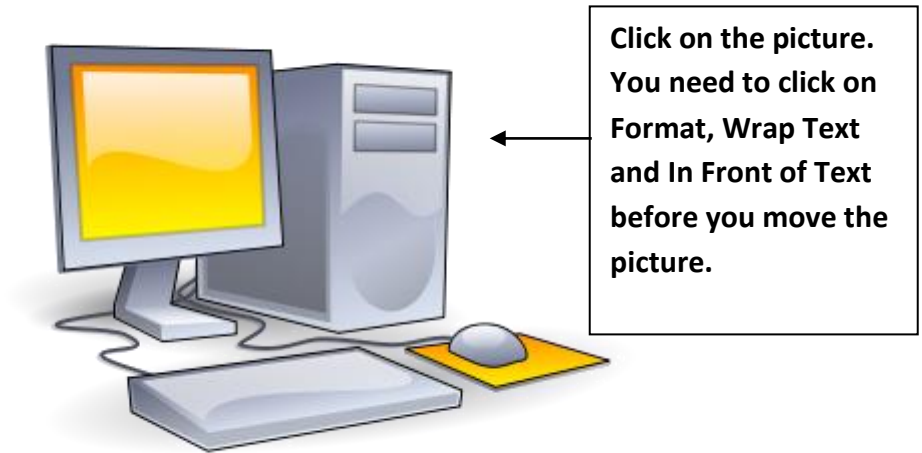

### Reminders:

- One space **after** each word
- One space **after** each period - (Correct: I went to the store.) (**Incorrect: I like pizza .**)
- One space **after** each comma - (Correct: I like pizza, chips, and candy.) (**Incorrect: I like pizza , chips , and candy.**)